

SPEAKERS PANEL (LIQUOR LICENSING)

Day: Tuesday
Date: 1 November 2016
Time: 10.00 am
Place: Lesser Hall 2 - Dukinfield Town Hall

Item No.	AGENDA	Page No
1.	DECLARATIONS OF INTEREST To receive any declarations of interest from Members of the Panel.	
2.	APPLICATION FOR A PREMISES LICENCE - CONVENIENCE STORE, SHOWGROUND FILLING STATION, HYDE ROAD, MOTTRAM Report of the Assistant Executive Director (Environmental Services) attached.	1 - 30
3.	APPLICATION FOR A PREMISES LICENCE - CONVENIENCE STORE, HYDE ROAD FILLING STATION, HYDE ROAD, MOTTRAM Report of the Assistant Executive Director (Environmental Services) attached.	31 - 54

This page is intentionally left blank

Agenda Item 2

Report To:	SPEAKERS PANEL (LIQUOR LICENSING)
Date:	1 November 2016
Executive Member / Reporting Officer:	Ian Saxon – Assistant Executive Director (Environmental Services)
Subject:	APPLICATION FOR A PREMISES LICENCE – CONVENIENCE STORE, SHOWGROUND FILLING STATION, HYDE ROAD, MOTTRAM, HYDE.
Report Summary:	Members are requested to determine the application.
Recommendations:	<p>Having regard to the application and the relevant representations, Members are invited to take such steps (if any) as it considers appropriate for the promotion of the licensing objectives. The steps available are:</p> <ul style="list-style-type: none">a) to grant the licence subject to –<ul style="list-style-type: none">i. such conditions that the authority considers appropriate for the promotion of the licensing objectives, andii. current mandatory conditions;b) to exclude from the scope of the licence any of the licensable activities to which the application relates;c) to refuse to specify a person in the licence as the premises supervisor;d) to reject the application.
Links to Community Strategy:	The licensing of premises under the Licensing Act 2003 contributes towards the Community Strategy theme of providing a safe environment.
Policy Implications:	Members are provided with policy guidelines to assist in the decision making process.
Financial Implications: (Authorised by the Borough Treasurer)	There are limited financial implications for the Council, as detailed in the report, however, any legal challenge to a policy decision may potentially incur costs.
Legal Implications:(Authorised by the Borough Solicitor)	Any decision to revoke a licence or impose amendments or conditions to a licence can be challenged by way of appeal (in the first instance) to the local Magistrates Court.
Risk Management:	Failure to give full consideration to the determination of licensing issues has the potential to impact on public safety, and also the right of an individual to earn a living
Access to Information	The author of the report is John Gregory – Licensing Manager:-  Telephone - 0161 342 3520

1. INTRODUCTION

- 1.1 Section 176 (1) and (2)(b) of the Licensing Act 2003 specifically prohibits Licensing Authorities from granting premises licences allowing the sale or supply of alcohol from premises used primarily as a garage.
- 1.2 Section 176 (4)(c) further defines a garage as a premises which is used for one or more of the following:
- 1) The retailing of petrol;
 - 2) The retailing of derv (diesel);
 - 3) The sale of motor vehicles; and
 - 4) The maintenance of motor vehicles.

2. REPORT

- 2.1 On 6 September 2016 the Licensing Department received an application from Motor Fuel Ltd for a premises licence under the Licensing Act 2003. The applicant has applied to licence a Convenience store for the sale alcohol and the provision of late night refreshment at Showground Filling Station, Hyde Road, Mottram, Hyde, SK14 6NG. The hours applied for can be seen in the application attached at **Appendix 1**.

3. REPRESENTATIONS & EVIDENCE SUBMITTED

- 3.1 Representations to this application have been received from Tameside MBC Licensing, Tameside MBC Trading Standards and Greater Manchester Police in their roles as responsible authorities. A member of the public has also submitted a representation.

Licensing, Trading Standards & Greater Manchester Police

- 3.2 All three representations from the Responsible Authorities named above, share the same theme. Licensing Officer, Business Compliance Officer and representative of Greater Manchester Police all highlight the premises are primarily a petrol station. In addition to this, they go on to point out that the applicant has submitted projections of estimated customer flow if the premises licence were to be granted. Actual customer data records are not included in the application.
- 3.3 The representation from Tameside MBC Licensing can be found at **Appendix 2**, the Tameside Trading Standards representation at **Appendix 3** and Greater Manchester Police representation at **Appendix 4**.

Public Representation

- 3.4 A member of the public has raised concerns with regard to youths being attracted to the area if alcohol were to be on sale from this premise, leading to anti-social behaviour. The full representation can be seen at **Appendix 5**.

4. CONCLUSION AND OPTIONS FOR THE PANEL

- 4.1 Panel are requested to consider the evidence and decide what (if any) steps to take as it considers appropriate for the promotion of the licensing objectives. The options available to the Panel are;
- a) to grant the licence subject to –
 - i. such conditions that the authority considers appropriate for the promotion of the licensing objectives; and

- ii. current mandatory conditions;
- b) to exclude from the scope of the licence any of the licensable activities to which the application relates;
- c) to refuse to specify a person in the licence as the premises supervisor;
- d) to reject the application.

This page is intentionally left blank

4/10/16

Licensing Solutions

32 Church Road, Locks Heath Southampton SO31 6LU

Tel 07831 159 450

Fax 01489 583932

chris@licensingolutions.org.uk

ENVIRONMENTAL PROTECTION
TMBC
TAM & JAMES DOR

5th September 2016

Dear Sir,

Re: Section 17 Premises Licence Applications – MFG Showground FS405

Please find enclosed a copy of our application for a Premises Licence on behalf of our client in respect of the premises listed as above in Hyde Road with a submission date of Wednesday the 7th September as per the notice in the application documentation.

Please note that the DPS will be varied to the manager in day to day control of Licensable Activity before any sales commence.

We have also enclosed a copy of the master application, plan and DPS consent form together with a copy of the notice displayed on the premises and advertised in a local newspaper plus further information in support of the application.

We can confirm that copies of the application bundle have been served on the Responsible Authorities as listed below, and that an advertisement has been placed in a newspaper circulating in the area.

We trust that you will find that the application is in order but should you have any queries please do not hesitate to contact us in the first instance,
Yours faithfully

Chris Mitchener FBI

cc Applicant
Licensing – TMBC
GM Police AUL
GM Fire Service Hyde
TMBC Environmental Protection
TMBC Health & Safety
TMBC Planning
TMBC Trading Standards
TMBC Child Protection
Ashton Primary Care Centre Public Health

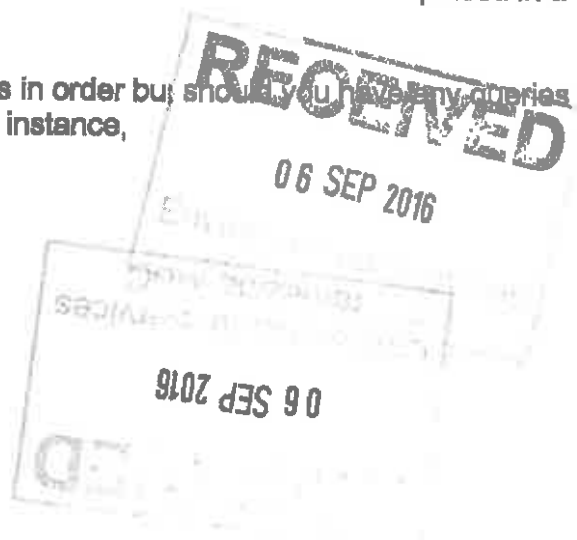

a division of the Retail Services & Design Group

Licensing Solutions

32 Church Road, Locks Heath Southampton SO31 6LU

Tel 07831 159 450

Fax 01489 583932

chris@licensingolutions.org.uk

5th September 2016

Licensing Manager
Licensing Section
Tameside Metropolitan Borough Council
Tame Street Depot
Tame Street
Stalybridge SK15 1ST

Dear Sir,

Re: Section 17 Premises Licence Applications – MFG Showground FS405

Please find enclosed our application for a Premises Licence on behalf of our client in respect of the premises listed as above in Hyde Road with a submission date of Wednesday the 7th September as per the notice in the application documentation, together with our cheque in the sum of £190 being the fee due in this matter.

Please note that the DPS will be varied to the manager in day to day control of Licensable Activity before any sales commence.

We have also enclosed a copy of the master application, plan and DPS consent form together with a copy of the notice displayed on the premises and advertised in a local newspaper plus further information in support of the application.

We can confirm that copies of the application bundle have been served on the Responsible Authorities as listed below, and that an advertisement has been placed in a newspaper circulating in the area.

We trust that you will find that the application is in order but should you have any queries please do not hesitate to contact us in the first instance,
Yours faithfully

Chris Mitchener FBI/tp

cc Applicant
Licensing – TMBC
GM Police AUL
GM Fire Service Hyde
TMBC Environmental Protection
TMBC Health & Safety
TMBC Planning
TMBC Trading Standards
TMBC Child Protection
Ashton Primary Care Centre Public Health



a division of the Retail Services & Design Group

Licensing Solutions

32 CHURCH ROAD, LOCKS HEATH, SOUTHAMPTON SO31 6LU
Tel 07831 159450 Fax 01489 583932 chris@licensingsolutions.org.uk

Premises Licence Application

on behalf of the

Convenience Store

Motor Fuel Limited

Showground Filling Station FS405

Hyde Road

Mottram

Hyde SK14 6NG

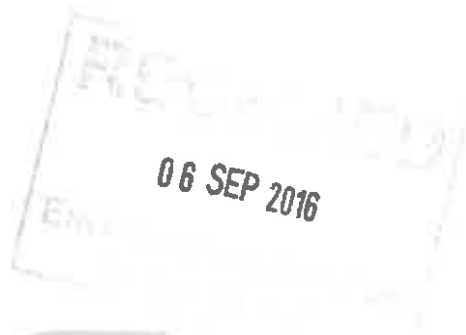

mfg
motor fuel group

a division of the Retail Services & Design Group

Background History

This site is an existing forecourt and shop which has been acquired by our clients and is to be traded by the applicants much as the other sites that they operate. The shop is being re-ranged and re-merchandised to the Convenience Store format to fully realise its trading potential. This includes installing a Costa Coffee machine, a cash machine, Camelot and Paypoint where applicable, and enhancing the retail offer across the range adapting and replacing fittings as necessary.

The Shop

The new shop layout has been designed to serve both the local community and those from further afield. Trading as a convenience store under the Company's own tried and tested convenience format a good range of fresh foods, groceries and other products are to be offered and the off licence is an important part of the service that such a shop is now expected to provide.

The Operation

The shop is operated by the Manager assisted by a team of staff who live locally. The DPS trained and certified through the national APLH certificate scheme will be responsible for training all staff and keeping and maintaining ongoing training records utilising the Off Licence Training System. The refusals system will be used with records kept in the Refusals Book to tie in with the CCTV system. The Challenge 25 trading initiative will also be embraced.

Security

The premises are secured by an alarm system and the CCTV system will benefit from cameras supported by a 24 hour recorder and library which can be made available to the Police if required.

Trading Hours

	Opening Hours	Alcohol supply	L N R
Mon – Sat	00.00 to 24.00	06.00 to 23.00	23.00 to 05.00
Sun	00.00 to 24.00	06.00 to 23.00	23.00 to 05.00

Summary

Enhanced Convenience trading format

Off-Licence Training System

Refusals Book

Alarm System

Challenge 25

CCTV

24 hour record with library

PUBLIC NOTICE OF AN APPLICATION FOR A PREMISES LICENCE UNDER SECTION 17 OF THE LICENSING ACT 2003

Notice is hereby given that an application was made to
TAMESIDE METROPOLITAN BOROUGH COUNCIL for a
premises licence under the above Act on the
7th SEPTEMBER 2016

Applicant: **MOTOR FUEL LTD**

Address of premises: **CONVENIENCE STORE
SHOWGROUND FILLING STATION
HYDE ROAD, MOTTRAM
HYDE SK14 6NG**

Proposed licensable activities:

**SALE OF ALCOHOL FOR CONSUMPTION OFF THE PREMISES
AND THE PROVISION OF LATE NIGHT REFRESHMENT**

Proposed days and hours of licensable activity:

ALCOHOL SALES	EVERY DAY 06.00 TO 23.00
LATE NIGHT REFRESHMENT	23.00 TO 05.00

The postal address of the Licensing Authority where the register is kept and the application may be inspected is:

**TAMESIDE METROPOLITAN BOROUGH COUNCIL,
LICENSING TEAM, TAME STREET DEPOT, TAME STREET,
STALYBRIDGE, SK15 1ST**

Any person wishing to make representations on this matter shall give notice, in writing, stating the nature and grounds for making such representations to The Licensing Officer at the above address within 28 days of the date of this notice – by the
5th OCTOBER 2016.

Further information is available on the web site
www.tameside.gov.uk following the links.

It is an offence, under section 158 of the Licensing Act 2003, to knowingly or recklessly make a false statement in or in connection with an application, and the maximum fine on summary conviction of such an offence is £5000.

Licensing Solutions – duly authorised agents

Application for a premises licence to be granted under the Licensing Act 2003

PLEASE READ THE FOLLOWING INSTRUCTIONS FIRST

Before completing this form please read the guidance notes at the end of the form. If you are completing this form by hand please write legibly in black capitals. In all cases ensure that your answers are inside the boxes and written in black ink. Use additional sheets if necessary.

You may wish to keep a copy of this completed form for your records.

L/VO MOTOR FUEL LTD
(Name(s) of applicant)
apply for a premises licence under section 17 of the Licensing Act 2003 for the premises described in Part 1 below (the premises) and I/we are making this application to you as the relevant licensing authority in accordance with section 12 of the Licensing Act 2003

Part 1 - Premises Details

Postal address of premises or, if none, address survey map reference or description

CONVENIENCE STORE
SHOWGROUND FILLING STATION ROAD
HYDE ROAD
MOTTRAM

Post town	HYDE	Postcode	REK14 6RG
-----------	------	----------	-----------

Telephone number at premises (if any) **01457 763 781**

Non-domestic rateable value of premises

Part 2 - Applicant Details

Please state whether you are applying for a premises licence as

Please tick as appropriate

- a) an individual or individuals * please complete section (A)
- b) a person other than an individual *
 - i. as a limited company please complete section (B)
 - ii. as a partnership please complete section (B)
 - iii. as an unincorporated association or other (for example a statutory corporation) please complete section (B)
 - iv. a non-registered club please complete section (B)
 - v. a charity please complete section (B)

- a) the proprietor of an educational establishment please complete section (B)
- b) a health service body please complete section (B)
- c) a person who is registered under Part 2 of the Care Standards Act 2000 (c14) in respect of an independent hospital in Wales please complete section (B)
- d) a person who is registered under Chapter 2 of Part 1 of the Health and Social Care Act 2008 (within the meaning of that Part) in an independent hospital in England please complete section (B)
- e) the chief officer of police of a police force in England and Wales please complete section (B)

* If you are applying as a person described in (c) or (d) please confirm:

Please tick yes

I am carrying on or proposing to carry on a business which involves the use of the premises for licensable activities; or

I am making the application pursuant to a statutory function or

a function delegated by virtue of Her Majesty's prerogative

(A) INDIVIDUAL APPLICANTS (fill in as applicable)

Mr	<input type="checkbox"/>	Mrs	<input type="checkbox"/>	Miss	<input type="checkbox"/>	Ms	<input type="checkbox"/>	Other Title (for example, Rev)	
Surname	First names								
I am 16 years old or over <input type="checkbox"/> Please tick yes									
Current postal address if different from premises address									
Post town								Postcode	
Premises contact telephone number									
E-mail address (optional)									

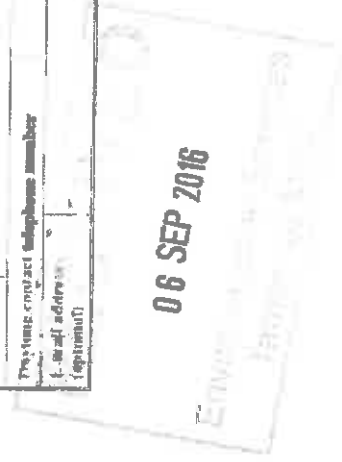

Part 3 Operating Schedule

When do you want the premises license to start?

DD MM YYYY
 0 6 1 2 0 1 6

If you wish the license to be valid only for a limited period, when do you want it to end?

DD MM YYYY
 0 6 1 2 0 1 6

Please give a general description of the premises (please read guidelines notes 1) GROUND FLOOR CONVENIENCE STORE SITED ON A FORECOURT TRADING AS A NEW FORMAT CONVENIENCE STORE WITH AN IMPROVED RANGE OF FRESH FOODS GROCERIES DAIRY PRODUCTS CONFECTIONARY SOFT DRINKS AND TOBACCO PRODUCTS ON OFFER WITH PARKING AVAILABLE FOR CUSTOMERS ON THE FORECOURT

If 5,000 or more people are expected to attend the premises at any one time, please state the number expected to attend.

What licensable activities do you intend to carry on from the premises?

(Please see sections 1 and 14 of the Licensing Act 2003 and Schedules 1 and 2 to the Licensing Act 2003)

- Provision of regulated entertainment
- Please tick any that apply
- a) plays (if ticking yes, fill in box A)
 - b) films (if ticking yes, fill in box B)
 - c) indoor sporting events (if ticking yes, fill in box C)
 - d) boxing or wrestling entertainment (if ticking yes, fill in box D)
 - e) live music (if ticking yes, fill in box E)
 - f) recorded music (if ticking yes, fill in box F)
 - g) performances of drama (if ticking yes, fill in box G)
 - h) anything of a similar description to that falling within (e), (f) or (g) (if ticking yes, fill in box H)

SECOND INDIVIDUAL APPLICANT (if applicable)

Mr Ms Miss Mx Other Title (for example, Rev)

Surname _____ First names _____

I am 18 years old or over Please tick yes

Current postal address if different from premises address _____

Postcode _____

Daytime contact telephone number _____

E-mail address (optional) _____

(3) OTHER APPLICANTS

Please provide name and registered address of applicant in full. Where appropriate please give any registered number. In the case of a partnership or other joint venture (other than a body corporate), please give the name and address of each party concerned.

Name MOTOR FUEL LIMITED

Address BUILDING 2
 ABBEY VIEW
 EVERARD CLOSE
 ST ALBANS
 HERTS AL1 2QU

Registered number (where applicable) 5206547

Description of applicant (for example, partnership, company, unincorporated association etc.) COMPANY

Telephone number (if any) 01727 898830

E-mail address (optional) _____

Participation of job site staff representatives (if ticking yes, fill in box D)

X

Summary of schedule (if ticking yes, fill in box E)

X

In all cases complete boxes K, L and M

A

Plays Standard days and timings (please read guidance note 6)		Will the participation of a play take place indoors or outdoors or both - please tick (please read guidance note 4)		
Day	Start	Finish	Indoors	Outdoors
Mon			<input type="checkbox"/>	<input type="checkbox"/>
Tue			<input type="checkbox"/>	<input type="checkbox"/>
Wed			<input type="checkbox"/>	<input type="checkbox"/>
Thur			<input type="checkbox"/>	<input type="checkbox"/>
Fri			<input type="checkbox"/>	<input type="checkbox"/>
Sat			<input type="checkbox"/>	<input type="checkbox"/>
Sun			<input type="checkbox"/>	<input type="checkbox"/>

Please also further details here (please read guidance note 3)

State any unusual variations for participation plays (please read guidance note 6)

Non standard fixtures. Where you intend to use the premises for the participation of others at different times to those listed in the columns on the left, inform us (please read guidance note 5)

B

Plays Standard days and timings (please read guidance note 6)		Will the participation of plays take place indoors or outdoors or both - please tick (please read guidance note 3)		
Day	Start	Finish	Indoors	Outdoors
Mon			<input type="checkbox"/>	<input type="checkbox"/>
Tue			<input type="checkbox"/>	<input type="checkbox"/>
Wed			<input type="checkbox"/>	<input type="checkbox"/>
Thur			<input type="checkbox"/>	<input type="checkbox"/>
Fri			<input type="checkbox"/>	<input type="checkbox"/>
Sat			<input type="checkbox"/>	<input type="checkbox"/>
Sun			<input type="checkbox"/>	<input type="checkbox"/>

Please also further details here (please read guidance note 3)

State any unusual variations for the participation of plays (please read guidance note 4)

Non standard fixtures. Where you intend to use the premises for the participation of others at different times to those listed in the columns on the left, inform us (please read guidance note 5)

C

Indoor sporting events Standard days and timings (please read guidance note 6)		Please also further details (please read guidance note 3)	
Day	Start	Finish	
Mon			
Tue			State any unusual variations for indoor sporting events (please read guidance note 4)
Wed			
Thur			Non standard times. Where you intend to use the venues for indoor sporting events at different times to those listed in the column on the left, please list (please read guidance note 5)
Fri			
Sat			
Sun			

D

Booking or wrestling entertainment Standard days and timings (please read guidance note 2)		Will the booking or wrestling entertainment take place indoors, outdoors or both – please tick (please read guidance note 2)		
Day	Start	Finish	Indoors	Outdoors
Mon			<input type="checkbox"/>	<input type="checkbox"/>
Tue			Please also further details here (please read guidance note 3)	
Wed			State any unusual variations for booking or wrestling entertainment (please read guidance note 4)	
Thur				
Fri			Non standard times. Where you intend to use the venues for booking or wrestling entertainment at different times to those listed in the column on the left, please list (please read guidance note 5)	
Sat				
Sun				

I

Live music Standard days and times (please read guidance note 6)		Will the performance of live music take place indoors or outdoors or both - please tick (please read guidance note 2)	Indoors Outdoors Both
Day	Start		
Mon			<input type="checkbox"/>
Tue			<input type="checkbox"/>
Wed			<input type="checkbox"/>
Thur			
Fri			
Sat			
Sun			

Will the performance of live music take place indoors or outdoors or both - please tick (please read guidance note 2)

Please give further details here (please read guidance note 3)

State any essential restrictions for the performance of live music (please read guidance note 4)

Non-essential details. Where you intend to use the premises for the performance of live music at different times in the future, in the columns on the left, please tick (please read guidance note 5)

V

Recorded music Standard days and times (please read guidance note 6)		Will the playing of recorded music take place indoors or outdoors or both - please tick (please read guidance note 2)	Indoors Outdoors Both
Day	Start		
Mon			<input type="checkbox"/>
Tue			<input type="checkbox"/>
Wed			<input type="checkbox"/>
Thur			
Fri			
Sat			
Sun			

Will the playing of recorded music take place indoors or outdoors or both - please tick (please read guidance note 2)

Please give further details here (please read guidance note 3)

State any essential restrictions for the playing of recorded music (please read guidance note 4)

Non-essential details. Where you intend to use the premises for the playing of recorded music at different times in the future, in the columns on the left, please tick (please read guidance note 5)

G

Performances of dance Standard days and timings (please read guidance note 6)		Will the performance of dance take place indoors or outdoors or both - please tick (please read guidance note 2)		
Day	Start	Finish	Indoors	Outdoors
Mon			<input type="checkbox"/>	<input type="checkbox"/>
Tue			<input type="checkbox"/>	<input type="checkbox"/>
Wed			<input type="checkbox"/>	<input type="checkbox"/>
Thur			<input type="checkbox"/>	<input type="checkbox"/>
Fri			<input type="checkbox"/>	<input type="checkbox"/>
Sat			<input type="checkbox"/>	<input type="checkbox"/>
Sun			<input type="checkbox"/>	<input type="checkbox"/>

Will the performance of dance take place indoors or outdoors or both - please tick (please read guidance note 2)

Please give further details here (please read guidance note 3)

State any seasonal variations for the performance of dance (please read guidance note 4)

Non standard timings. Where you intend to use the premises for the performance of dance at times not listed in the column set the left, please tick (please read guidance note 5)

H

Anything of a similar description to that falling within (a), (b) or (c) Standard days and timings (please read guidance note 6)		Please give a description of the type of entertainment you will be providing		
Day	Start	Finish	Indoors	Outdoors
Mon			<input type="checkbox"/>	<input type="checkbox"/>
Tue			<input type="checkbox"/>	<input type="checkbox"/>
Wed			<input type="checkbox"/>	<input type="checkbox"/>
Thur			<input type="checkbox"/>	<input type="checkbox"/>
Fri			<input type="checkbox"/>	<input type="checkbox"/>
Sat			<input type="checkbox"/>	<input type="checkbox"/>
Sun			<input type="checkbox"/>	<input type="checkbox"/>

Will this entertainment take place indoors or outdoors or both - please tick (please read guidance note 2)

Please give further details here (please read guidance note 3)

State any seasonal variations for entertainment of a similar description to that falling within (a), (b) or (c) (please read guidance note 4)

Non standard timings. Where you intend to use the premises for the entertainment of a similar description to that falling within (a), (b) or (c) at different times to those listed in the column set the left, please tick (please read guidance note 5)

I

Late night refreshment Standard days and timings (please read guidance note 6)		Will the provision of late night refreshment take place indoors or outdoors or both - please tick (please read guidance note 2)		Indoors	Outdoors	Both
Day	Start	Finish				
Mon	00.00	05.00				
	23.00	24.00				
Tue	00.00	05.00				
	23.00	24.00				
Wed	00.00	05.00				
	23.00	24.00				
Thur	00.00	05.00				
	23.00	24.00				
Fri	00.00	05.00				
	23.00	24.00				
Sat	00.00	05.00				
	23.00	24.00				
Sun	00.00	05.00				
	23.00	24.00				

Will the provision of late night refreshment take place indoors or outdoors or both - please tick (please read guidance note 2)

Please give further details here (please read guidance note 3)

Shots are exempt refreshment for the provision of late night refreshment (please read guidance note 4)

Non standard hours. Where you intend to use the premises for the provision of late night refreshment at different times, to those listed in the schedule on the left, please list (please read guidance note 5)

J

Supply of alcohol Standard days and timings (please read guidance note 6)		Will the supply of alcohol be for consumption - please tick (please read guidance note 7)		On the premises	Off the premises	Both
Day	Start	Finish				
Mon	05.00	23.00				
Tue	05.00	23.00				
Wed	05.00	23.00				
Thur	05.00	23.00				
Fri	05.00	23.00				
Sat	05.00	23.00				
Sun	05.00	23.00				

Will the supply of alcohol be for consumption - please tick (please read guidance note 7)

Shots are exempt refreshment for the supply of alcohol (please read guidance note 4)

Non standard hours. Where you intend to use the premises for the supply of alcohol at different times to those listed in the schedule on the left, please list (please read guidance note 5)

State the name and details of the individual whom you wish to specify on the licence as designated premises supervisor:

Name: CHRISTOPHER JOHN MITCHENER

Address:

Postcode:

Personal licence number (if known): 2005004070699BC

Issuing licensing authority (if known): EASTLEIGH BOROUGH COUNCIL

M Describe the steps you intend to take to promote the four licensing objectives:

- a) General - all four licensing objectives (b, c, d and e) (please read guidance note 4)
- ALARM SYSTEM WITH PANIC BUTTONS, CCTV SYSTEM WITH RECORDING FACILITIES AND 28 DAY LIBRARY, TRAINED STAFF WITH RECORDED ONGOING ALCOHOL TRAINING REGIME, CHALLENGE 25 AND PROOF OF AGE INITIATIVE EMBRACED, INITIATIVE CHALLENGE SGNAGE, REFUSALS SYSTEM WITH REFUSALS BOOK AND INCIDENT BOOK
- b) The protection of children and vulnerable adults
- CCTV SYSTEM WITH RECORDING FACILITY, TRAINED STAFF, CHALLENGE 25, REFUSALS SYSTEM
- c) Public safety
- STAFF TRAINED IN FIRE SAFETY PROCEDURES AND THE USE OF FIRE SAFETY EQUIPMENT, FIRE FIGHTING EQUIPMENT
- d) The prevention of public nuisance
- STAFF TRAINED TO DEAL WITH SITUATIONS, USEABLE WASTE BINS PROVIDED ON THE FORECOURT
- e) The prevention of children from being
- FULL ALCOHOL TRAINING REGIME IN USE, ONGOING RECORDED ALCOHOL TRAINING AND REFRESHER TRAINING, CHALLENGE 25 TRAINING INITIATIVE EMBRACED, CHALLENGE SGNAGE, REFUSALS SYSTEM AND REFUSALS BOOK AND INCIDENT LOG IN USE

K

Please highlight any adult entertainment or services, activities, other entertainment or matters ancillary to the use of the premises that may give rise to concern in respect of children (please read guidance note 5)

NONE

L

Hours premises are open to the public

Standard days and timings (please read guidance note 5)

Day	Start	Finish
Mon	00.00	24.00
Tue	00.00	24.00
Wed	00.00	24.00
Thur	00.00	24.00
Fri	00.00	24.00
Sat	00.00	24.00
Sun	00.00	24.00

Hours vary seasonal variations (please read guidance note 4)

None standard business. Where you intend the premises to be open to the public at different times from those listed in the columns on the left please list (please read guidance note 5)

Checklist:

- Please tick to indicate agreement
- I have made or enclosed payment of the fee. X
 - I have enclosed the plan of the premises. X
 - I have sent copies of this application and the plan to responsible authorities and others where applicable. X
 - I have enclosed the consent form completed by the individual I wish to be designated premises supervisor, if applicable. X
 - I understand that I must notify authorities my application. X
 - I understand that if I do not comply with the above requirements my application will be rejected. X

IT IS AN OFFENCE, LIABLE ON SUMMARY CONVICTION TO A FINE NOT EXCEEDING LEVIES 6 ON THE STANDARD SCALE, UNDER SECTION 156 OF THE LICENSING ACT 2003, TO MAKE A FALSE STATEMENT IN OR IN CONNECTION WITH THIS APPLICATION.

Part 4 - Signatures (please read guidance note 10)

Signature of applicant or applicant's partner or other duly authorised person (please read guidance note 11).
If signing on behalf of the applicant, please state in what capacity

Signature		videance note 11).
Date	5 th September 2016	
Capacity	LICENSING SOLUTIONS - DULY AUTHORISED AGENT	

For joint applications, signature of 1st applicant or 2nd applicant's partner or other authorised agent (please read guidance note 12). If signing on behalf of the applicant, please state in what capacity.

Signature	
Date	
Capacity	

Contact name (where not previously given) and postal address for correspondence associated with this application (please read guidance note 13)

LICENSING SOLUTIONS
52 CRURCH ROAD
LOCKES HEATH

Post town SOUTHAMPTON Postcode SO14 6JF
Telephone number (if any) 07831 159 480

If you would prefer us to correspond with you by e-mail, your e-mail address (optional)
sams@licensingsolutions.co.uk

Notes for Guidance

1. Describe the premises, for example the type of premises, its general situation and layout and any other information which could be relevant to the licensing objectives. Where your application includes off-licenses of alcohol and you intend to provide a place for consumption of flame off-licenses, you must include a description of where this place will be and its proximity to the premises.
2. Where taking place in a building or other structure please tick an appropriate (note: you may include a tent).
3. For example the type of activity to be authorized, if not already stated, and give relevant further details, for example (but not exclusively) whether or not music will be amplified or amplified, summer or winter.
4. For example (but not exclusively), when the activity will occur on additional days during the summer or winter.
5. For example (but not exclusively), when you wish the activity to go on longer on a particular day e.g. Christmas Eve.
6. Please give timings in 24 hour clock (e.g. 1600) and only give details for the days of the week when you intend the premises to be used for the activity.
7. If you wish people to be able to consume alcohol on the premises, please tick 'on the premises'. If you wish people to be able to purchase alcohol to consume away from the premises, please tick 'off the premises'. If you wish people to be able to do both, please tick 'both'.
8. Please give information about anything intended to occur at the premises or ancillary to the use of the premises which may give rise to concern in respect of children, regardless of whether you intend children to have access to the premises, for example (but not exclusively) nudity or semi-nudity, films for restricted age groups or the presence of gaming machines.
9. Please list here steps you will take to promote all four licensing objectives together.
10. The applicant's agent (for example solicitor) may sign the form on their behalf provided that they have actual authority to do so.
11. An applicant's agent (for example solicitor) may sign the form on their behalf provided that they have actual authority to do so.
12. Where there is more than one applicant, each of the applicant or their respective agents must sign the application form.
13. This is the address which we shall use to correspond with you about this application.

Consent of individual to being specified as premises supervisor

ICHRISTOPHER JOHN MITCHENER.....
[full name of prospective premises supervisor]

of.....

.....
[home address of prospective premises supervisor]

hereby confirm that I give my consent to be specified as the designated premises supervisor in relation to the application forA NEW PREMISES LICENCE.....[type of application]

by.....MOTOR FUEL LIMITED[name of applicant]

relating to a premises licenceNEW APPLICATION.....
[number of existing licence, if any]

for..... SHOWGROUND FILLING STATION, HYDE ROAD, MOTTRAM, HYDE SK14 6NG.....
[name and address of premises to which the application relates]

and any premises licence to be granted or varied in respect of this application made byMOTOR FUEL LIMITED[name of applicant]

concerning the supply of alcohol at SHOWGROUND FILLING STATION, HYDE ROAD, MOTTRAM, HYDE SK14 6NG

[name and address of premises to which application relates].

I also confirm that I am applying for, intend to apply for or currently hold a personal licence, details of which I set out below.

Personal licence number.....2005/00407/06EPEC.....
[insert personal licence number, if any]

Personal licence issuing authorityEASTLEIGH BOROUGH COUNCIL
[insert name and address and telephone number of personal licence issuing authority, if any]

... .signed

.....CHRIS MITCHENER.....name (please print)

.....2ND SEPTEMBER 2016.....dated





Allowance display table layout can still implement the plan for the

		<p>2. APPROVED BY THE PROJECT MANAGER 3. APPROVED BY THE PROJECT MANAGER 4. APPROVED BY THE PROJECT MANAGER 5. APPROVED BY THE PROJECT MANAGER</p>	
<p>DATE: _____</p>		<p>PROJECT NO: _____</p>	
<p>PROJECT NAME: _____</p>		<p>PROJECT LOCATION: _____</p>	
<p>PROJECT MANAGER: _____</p>		<p>PROJECT STATUS: _____</p>	
<p>PROJECT DESCRIPTION: _____</p>		<p>PROJECT START DATE: _____</p>	
<p>PROJECT END DATE: _____</p>		<p>PROJECT BUDGET: _____</p>	
<p>PROJECT RISK: _____</p>		<p>PROJECT COMPLETION: _____</p>	

Analysis of Projected Customer Flow
Client Name: Motor Fuel Ltd - Convenience Store
Showground

	Shop Sales - £	Average Shop Purchase - £	Number of Shop Customers	Number of Fuel Customers	Average Fuel Purchase - Litres	Fuel Sales - Litres
Month 1	24618	2.72	9051	7291	19.87	144876
Month 2	25135	2.75	9125	7317	19.86	145282
Month 3	25663	2.79	9202	7342	19.84	145688
Month 4	26202	2.82	9280	7368	19.83	146096
Month 5	26752	2.86	9361	7393	19.82	146505
Month 6	27314	2.89	9444	7419	19.80	146916
Month 7	27887	2.93	9529	7445	19.79	147327
Month 8	28473	2.96	9616	7471	19.78	147740
Month 9	29071	3.00	9705	7497	19.76	148153
Month 10	29681	3.03	9796	7523	19.75	148568
Month 11	30305	3.06	9889	7549	19.74	148984
Month 12	30941	3.10	9984	7575	19.72	149401
Totals	332042	2.91	113981	89189	19.80	1765537

Analysis of Projected Customer Flow
Shop v Forecourt
Motor Fuel Ltd - Convenience Store
Showground



By virtue of paragraph(s) 3 of Part 1 of Schedule 12A
of the Local Government Act 1972.

Document is Restricted

This page is intentionally left blank

By virtue of paragraph(s) 3 of Part 1 of Schedule 12A
of the Local Government Act 1972.

Document is Restricted

This page is intentionally left blank

By virtue of paragraph(s) 3 of Part 1 of Schedule 12A
of the Local Government Act 1972.

Document is Restricted

This page is intentionally left blank

By virtue of paragraph(s) 3 of Part 1 of Schedule 12A
of the Local Government Act 1972.

Document is Restricted

This page is intentionally left blank

Agenda Item 3

Report To:	SPEAKERS PANEL (LIQUOR LICENSING)
Date:	1 November 2016
Executive Member / Reporting Officer:	Ian Saxon – Assistant Executive Director (Environmental Services)
Subject:	APPLICATION FOR A PREMISES LICENCE – CONVENIENCE STORE, HYDE ROAD FILLING STATION, HYDE ROAD, MOTTRAM, HYDE.
Report Summary:	Members are requested to determine the application.
Recommendations:	<p>Having regard to the application and the relevant representations, Members are invited to take such steps (if any) as it considers appropriate for the promotion of the licensing objectives. The steps available are:</p> <ul style="list-style-type: none">a) to grant the licence subject to –<ul style="list-style-type: none">i. such conditions that the authority considers appropriate for the promotion of the licensing objectives, andii. current mandatory conditions;b) to exclude from the scope of the licence any of the licensable activities to which the application relates;c) to refuse to specify a person in the licence as the premises supervisor;d) (d) to reject the application.
Links to Community Strategy:	The licensing of premises under the Licensing Act 2003 contributes towards the Community Strategy theme of providing a safe environment.
Policy Implications:	Members are provided with policy guidelines to assist in the decision making process.
Financial Implications: (Authorised by the Borough Treasurer)	There are limited financial implications for the Council, as detailed in the report, however, any legal challenge to a policy decision may potentially incur costs.
Legal Implications:(Authorised by the Borough Solicitor)	Any decision to revoke a licence or impose amendments or conditions to a licence can be challenged by way of appeal (in the first instance) to the local Magistrates Court.
Risk Management:	Failure to give full consideration to the determination of licensing issues has the potential to impact on public safety, and also the right of an individual to earn a living
Access to Information	The author of the report is John Gregory – Licensing Manager:-  Telephone - 0161 342 3520

1. INTRODUCTION

- 1.1 Section 176 (1) and (2)(b) of the Licensing Act 2003 specifically prohibits Licensing Authorities from granting premises licences allowing the sale or supply of alcohol from premises used primarily as a garage.
- 1.2 Section 176 (4)(c) further defines a garage as a premises which is used for one or more of the following:
- 1) The retailing of petrol;
 - 2) The retailing of derv (diesel);
 - 3) The sale of motor vehicles; and
 - 4) The maintenance of motor vehicles.

2. REPORT

- 2.1 On 6 September 2016 the Licensing Department received an application from Motor Fuel Ltd for a premises licence under the Licensing Act 2003. The applicant has applied to licence a Convenience store for the sale alcohol and the provision of late night refreshment at Hyde Road Filling Station, Hyde Road, Mottram, Hyde, SK14 6NG. The hours applied for can be seen in the application attached at **Appendix 1**.

3. REPRESENTATIONS & EVIDENCE SUBMITTED

- 3.1 Representations to this application have been received by Tameside MBC Licensing and Tameside MBC Trading Standards in their roles as responsible authorities.

Licensing & Trading Standards

- 3.2 Tameside MBC Licensing and Tameside MBC Trading Standards have both submitted representations that outline the same issues. Both have stated that the premises are primarily a petrol station. They go on to highlight that the applicant has submitted projections of estimated customer flow if the premises licence were to be granted. Actual customer data records are not included in the application.
- 3.3 The representation from Tameside MBC Licensing can be found at **Appendix 2** and the representation from Tameside MBC Trading Standards at **Appendix 3**.

4. CONCLUSION AND OPTIONS FOR THE PANEL

- 4.1 Panel are requested to consider the evidence and decide what (if any) steps to take as it considers appropriate for the promotion of the licensing objectives. The options available to the Panel are;
- a) to grant the licence subject to –
 - i. such conditions that the authority considers appropriate for the promotion of the licensing objectives; and
 - ii. current mandatory conditions;
 - b) to exclude from the scope of the licence any of the licensable activities to which the application relates;
 - c) to refuse to specify a person in the licence as the premises supervisor;
 - d) to reject the application.

4/10/16

Licensing Solutions

32 Church Road, Locks Heath Southampton SO31 6LU
Tel 07831 169 450 Fax 01489 583932 chris@licensingolutions.org.uk

5th September 2016

ENVIRONMENTAL PROTECTION
TAMESIDE MBC

Dear Sir,

Re: Section 17 Premises Licence Applications – MFG Hyde Road FS398

Please find enclosed a copy of our application for a Premises Licence on behalf of our client in respect of the premises listed as above in Hyde Road with a submission date of Wednesday the 7th September as per the notice in the application documentation.

Please note that the DPS will be varied to the manager in day to day control of Licensable Activity before any sales commence.

We have also enclosed a copy of the master application, plan and DPS consent form together with a copy of the notice displayed on the premises and advertised in a local newspaper plus further information in support of the application.

We can confirm that copies of the application bundle have been served on the Responsible Authorities as listed below, and that an advertisement has been placed in a newspaper circulating in the area.

We trust that you will find that the application is in order but should you have any queries please do not hesitate to contact us in the first instance.

Yours faithfully

Chris Mitchener FBllp

cc Applicant
Licensing – TMBC
GM Police AUL
GM Fire Service Hyde
TMBC Environmental Protection
TMBC Health & Safety
TMBC Planning
TMBC Trading Standards
TMBC Child Protection
Ashton Primary Care Centre Public Health

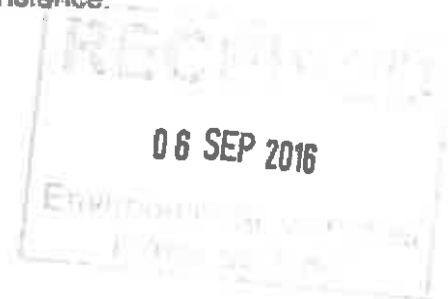

a division of the Retail Services & Design Group

Licensing Solutions

32 Church Road, Locks Heath Southampton SO31 6LU
Tel 07831 159 450 Fax 01489 583932 chris@licensingsolutions.org.uk

5th September 2016

Licensing Manager
Licensing Section
Tameside Metropolitan Borough Council
Tame Street Depot
Tame Street
Stalybridge SK15 1ST

Dear Sir,

Re: Section 17 Premises Licence Applications – MFG Hyde Road FS398

Please find enclosed our application for a Premises Licence on behalf of our client in respect of the premises listed as above in Hyde Road with a submission date of Wednesday the 7th September as per the notice in the application documentation, together with our cheque in the sum of £190 being the fee due in this matter.

Please note that the DPS will be varied to the manager in day to day control of Licensable Activity before any sales commence.

We have also enclosed a copy of the master application, plan and DPS consent form together with a copy of the notice displayed on the premises and advertised in a local newspaper plus further information in support of the application.

We can confirm that copies of the application bundle have been served on the Responsible Authorities as listed below, and that an advertisement has been placed in a newspaper circulating in the area.

We trust that you will find that the application is in order but should you have any queries please do not hesitate to contact us in the first instance,
Yours faithfully

Chris Mitchener FBII^{tz}

cc Applicant
Licensing – TMBC
GM Police AUL
GM Fire Service Hyde
TMBC Environmental Protection
TMBC Health & Safety
TMBC Planning
TMBC Trading Standards
TMBC Child Protection
Ashton Primary Care Centre Public Health

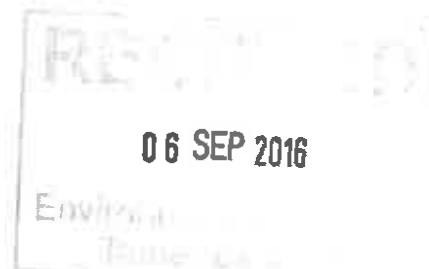

a division of the Retail Services & Design Group

Licensing Solutions

32 CHURCH ROAD, LOCKS HEATH, SOUTHAMPTON SO31 6LU

Tel 07831 159450

Fax 01489 583932

chris@licensingolutions.org.uk

Premises Licence Application

on behalf of the

Convenience Store

Motor Fuel Limited

Hyde Road Filling Station FS398

Hyde Road

Mottram

Hyde SK14 6NG



a division of the Retail Services & Design Group

Background History

This site is an existing forecourt and shop which has been acquired by our clients and is to be traded by the applicants much as the other sites that they operate. The shop is being re-ranged and re-merchandised to the **Convenience Store** format to fully realise its trading potential. This includes installing a Costa Coffee machine, a cash machine, Camelot and Paypoint where applicable, and enhancing the retail offer across the range adapting and replacing fittings as necessary.

The Shop

The new shop layout has been designed to serve both the local community and those from further afield. Trading as a convenience store under the Company's own tried and tested convenience format a good range of fresh foods, groceries and other products are to be offered and the off licence is an important part of the service that such a shop is now expected to provide.

The Operation

The shop is operated by the Manager assisted by a team of staff who live locally. The DPS trained and certified through the national APLH certificate scheme will be responsible for training all staff and keeping and maintaining ongoing training records utilising the **Off Licence Training System**. The refusals system will be used with records kept in the **Refusals Book** to tie in with the **CCTV** system. The **Challenge 25** trading initiative will also be embraced.

Security

The premises are secured by an alarm system and the **CCTV** system will benefit from cameras supported by a **24 hour recorder** and **library** which can be made available to the Police if required.

Trading Hours

	Opening Hours	Alcohol supply	L N R
Mon – Sat	00.00 to 24.00	06.00 to 23.00	23.00 to 05.00
Sun	00.00 to 24.00	06.00 to 23.00	23.00 to 05.00

Summary

Enhanced Convenience trading format

Off-Licence Training System

Refusals Book

Alarm System

Challenge 25

CCTV

24 hour record with library

PUBLIC NOTICE OF AN APPLICATION FOR A PREMISES LICENCE UNDER SECTION 17 OF THE LICENSING ACT 2003

Notice is hereby given that an application was made to **TAMESIDE METROPOLITAN BOROUGH COUNCIL** for a premises licence under the above Act on the **7th SEPTEMBER 2016**

Applicant: **MOTOR FUEL LTD**
Address of premises: **CONVENIENCE STORE
HYDE ROAD FILLING STATION
HYDE ROAD, MOTTRAM
HYDE SK14 6NG**

Proposed licensable activities:

SALE OF ALCOHOL FOR CONSUMPTION OFF THE PREMISES AND THE PROVISION OF LATE NIGHT REFRESHMENT

Proposed days and hours of licensable activity:

ALCOHOL SALES	EVERY DAY 06.00 TO 23.00
LATE NIGHT REFRESHMENT	23.00 TO 05.00

The postal address of the Licensing Authority where the register is kept and the application may be inspected is:

*** TAMESIDE METROPOLITAN BOROUGH COUNCIL,
LICENSING TEAM, TAME STREET DEPOT, TAME STREET,
STALYBRIDGE, SK15 1ST**

Any person wishing to make representations on this matter shall give notice, in writing, stating the nature and grounds for making such representations to The Licensing Officer at the above address within 28 days of the date of this notice – by the **5th OCTOBER 2016**.

Further information is available on the web site www.tameside.gov.uk following the links.

It is an offence, under section 158 of the Licensing Act 2003, to knowingly or recklessly make a false statement in or in connection with an application, and the maximum fine on summary conviction of such an offence is £5000.

Licensing Solutions – duly authorised agents

Application for a premises licence to be granted under the Licensing Act 2003

PLEASE READ THE FOLLOWING INSTRUCTIONS FIRST

Before completing this form please read the guidance notes at the end of the form. If you are completing this form by hand please write legibly in black capital letters. In all cases ensure that your answers are inside the boxes and written in black ink. Use additional sheets if necessary.

You may wish to keep a copy of this completed form for your records.

1/19 MOTOR FUEL LTD
(insert name of applicant)
apply for a premises licence under section 17 of the Licensing Act 2003 for the premises described in Part 1 below (the premises) and I/we are making this application to you in the relevant licensing authority in accordance with section 12 of the Licensing Act 2003

Part 1 - Premises Details

Postal address of premises or, if none, Ordnance Survey map reference or description

CONVENIENCE STORE
HYDE ROAD FILLING STATION FRODO
HYDE ROAD
MOUTRAK

Post town	HYDE	Postcode	SK16 6WG
-----------	------	----------	----------

Telephone number at premises (if any) 01457 767 591

Non-designable reliable value of premises

Part 2 - Applicant Details

Please state whether you are applying for a premises licence as

Please tick an appropriate

- a) an individual or individuals please complete section (B)
- b) a person other than an individual *
 - i. as a limited company please complete section (B)
 - ii. as a partnership please complete section (B)
 - iii. as an unincorporated association or please complete section (B)
 - iv. other (for example a statutory corporation) please complete section (B)
- c) a recognised club please complete section (B)
- d) a charity please complete section (B)

- e) the proprietor of an educational establishment please complete section (B)
- f) a health service body please complete section (B)
- g) a person who is registered under Part 2 of the Care Standards Act 2000 (614) in respect of an independent hospital in Wales please complete section (B)
- g1) a person who is registered under Chapter 2 of Part 1 of the Health and Social Care Act 2008 (within the meaning of that Part) in an independent hospital in England please complete section (B)
- h) the chief officer of police of a police force in England and Wales please complete section (B)

* If you are applying as a person described in (g) or (g) please confirm:

Please tick yes

I am carrying on or proposing to carry on a business which involves the use of the premises for licensable activities; or

I am making the application pursuant to a statutory function or

a function discharged by virtue of Her Majesty's prerogative

(A) INDIVIDUAL APPLICANTS (fill in as applicable)

Mr <input type="checkbox"/>	Mrs <input type="checkbox"/>	Miss <input type="checkbox"/>	Ms <input type="checkbox"/>	Other Title (for example, Rev) <input type="checkbox"/>
Surname		First names		
I am 18 years old or over <input type="checkbox"/> Please tick yes				
Current postal address if different from premises address				
Post town	Postcode			
Private contact telephone number				
E-mail address (optional)				



Part 3 Operating Schedule

When do you want the premises license to start?

DD MM YYYY
 b b b b b b

If you wish the license to be valid only for a limited period, when do you want it to end?

DD MM YYYY
 b b b b b b

Please give a general description of the premises (please read guidance note 1)
**GROUND FLOOR CONVENIENCE STORE SITED ON A FORECOURT TRADING AS A NEW
 FORMAT CONVENIENCE STORE WITH AN IMPROVED RANGE OF FRESH FOODS GROCERIES
 DAIRY PRODUCTS CONFECTIONARY SOFT DRINKS AND TOBACCO PRODUCTS ON OFFER
 WITH PARKING AVAILABLE FOR CUSTOMERS ON THE FORECOURT**

If 5,000 or more people are expected to attend the premises at any one time, please state the number expected to attend.

What licensable activities do you intend to carry on from the premises?

(Please see sections 1 and 14 of the Licensing Act 2003 and Schedules 1 and 2 to the Licensing Act 2003)

- Provision of regulated entertainment
- Please tick any that apply
- a) plays (if ticking yes, fill in box A)
 - b) films (if ticking yes, fill in box B)
 - c) indoor sporting events (if ticking yes, fill in box C)
 - d) boxing or wrestling entertainment (if ticking yes, fill in box D)
 - e) live music (if ticking yes, fill in box E)
 - f) recorded music (if ticking yes, fill in box F)
 - g) performances of dances (if ticking yes, fill in box G)
 - h) anything of a similar description to that falling within (e), (f) or (g) (if ticking yes, fill in box H)

SECOND INDIVIDUAL APPLICANT (if applicable)

Mr Ms Miss Mx Other Title (for example, Rev)

Surname First name

I am 18 years old or over Please tick you

Current postal address (if different from premises address)

Postcode

Daytime contact telephone number

E-mail address (optional)

(B) OTHER APPLICANTS

Please provide name and registered address of applicant in full. Where appropriate please give any registered number. In the case of a partnership or other joint venture (other than a body corporate), please give the name and address of each party concerned.

Name **MOTOR FUEL LIMITED**

Address **BUILDING 2
 ABBEY VIEW
 EVERARD CLOSE
 ST ALBANS
 HERTS AL1 2QU**

Registered number (where applicable) **5206547**

Description of applicant (for example, partnership, company, incorporated association etc.) **COMPANY**

Telephone number (if any) **01727 898890**

E-mail address (optional)

Exclusion of data subject's consent (if ticking yes, fill in box 1)

X

Storage of data (if ticking yes, fill in box 2)

X

In all cases complete boxes X, Y, and M

A

Plays		With the performance of a play (also when indoors or outdoors or both - please tick (please read guidance note 2)		
Standard days and times (please read guidance note 6)	Indoors	Outdoors	Both	
Day	Start	Finish		
Mon				Please give further details here (please read guidance note 3)
Tue				
Wed				
Thurs				Please give seasonal variations for performing plays (please read guidance note 4)
Fri				
Sat				Please standard times. Where you intend to use the premises for the performance of plays at different times in those listed in the columns on the left, please tick (please read guidance note 5)
Sun				

B

Films		With the exhibition of films (also when indoors or outdoors or both - please tick (please read guidance note 2)		
Standard days and times (please read guidance note 6)	Indoors	Outdoors	Both	
Day	Start	Finish		
Mon				Please give further details here (please read guidance note 3)
Tue				
Wed				
Thurs				Please give seasonal variations for the exhibition of films (please read guidance note 4)
Fri				
Sat				Please standard times. Where you intend to use the premises for the exhibition of films at different times to those listed in the columns on the left, please tick (please read guidance note 5)
Sun				

C

Indoor sporting events Standard days and timings (please read guidance note 6)		Please give further details (please read guidance note 3)	
Day	Start	Finish	
Mon			
Tue			Bitte may seasonal variations for indoor activities apply (please read guidance note 4)
Wed			
Thur			Non standard hours. Where you intend to use the premises for indoor activities occur at different times to those listed in the column on the left, please list (please read guidance note 5)
Fri			
Sat			
Sun			

D

Recreational or sporting activities Standard days and timings (please read guidance note 6)		Will the building or sporting activity be held in the place before or outdoors or both... please tick (please read guidance note 2)	
Day	Start	Finish	Indoors Outdoors Both
Mon			<input type="checkbox"/> <input type="checkbox"/> <input type="checkbox"/>
Tue			
Wed			Bitte may seasonal variations for leisure or sporting entertainment (please read guidance note 4)
Thur			
Fri			Non standard hours. Where you intend to use the premises for leisure or sporting activities occur at different times to those listed in the column on the left, please list (please read guidance note 5)
Sat			
Sun			

R

Lived music		When the performance of live music takes place indoors or outdoors or both - please tick (please read guidance note 2)	Indoors		
Standard days and times (please read guidance note 6)	Indoors		Outdoors	Both	
Day	Start	Finish			
Mon			<input type="checkbox"/>	<input type="checkbox"/>	<input type="checkbox"/>
Tue			Please give further details here (please read guidance note 3)		
Wed			State any seasonal variations for the performance of live music (please read guidance note 4)		
Thur					
Fri			Non standard times. Where you intend to use the premises for the performance of live music at different times to those listed in the column on the left, please list (please read guidance note 5)		
Sat					
Sun					

F

Recorded music		When the playing of recorded music takes place indoors or outdoors or both - please tick (please read guidance note 2)	Indoors		
Standard days and times (please read guidance note 6)	Indoors		Outdoors	Both	
Day	Start	Finish			
Mon			<input type="checkbox"/>	<input type="checkbox"/>	<input type="checkbox"/>
Tue			Please give further details here (please read guidance note 3)		
Wed			State any seasonal variations for the playing of recorded music (please read guidance note 4)		
Thur					
Fri			Non standard times. Where you intend to use the premises for the playing of recorded music at different times to those listed in the column on the left, please list (please read guidance note 5)		
Sat					
Sun					

I

Late night refreshment Standard days and timings (please read guidance note 6)		When the provision of late night refreshment takes place indoors or outdoors or both - please tick (please read guidance note 2)		Indoors	
Day	Start	Finish	Indoors	Outdoors	Both
Mon	00.00	05.00	<input checked="" type="checkbox"/>	<input type="checkbox"/>	<input type="checkbox"/>
Tue	00.00	05.00	<input type="checkbox"/>	<input type="checkbox"/>	<input type="checkbox"/>
Wed	00.00	05.00	<input type="checkbox"/>	<input type="checkbox"/>	<input type="checkbox"/>
Thu	00.00	05.00	<input type="checkbox"/>	<input type="checkbox"/>	<input type="checkbox"/>
Fri	00.00	05.00	<input type="checkbox"/>	<input type="checkbox"/>	<input type="checkbox"/>
Sat	00.00	05.00	<input type="checkbox"/>	<input type="checkbox"/>	<input type="checkbox"/>
Sun	00.00	05.00	<input type="checkbox"/>	<input type="checkbox"/>	<input type="checkbox"/>

Please also further details here (please read guidance note 3)

State any seasonal variations for the provision of late night refreshment (please read guidance note 4)

Non standard timings. Where you intend to use the premises for the provision of late night refreshment at different times to those listed in the columns on the left, please list (please read guidance note 5)

J

Supply of alcohol Standard days and timings (please read guidance note 6)		When the supply of alcohol is for consumption - please tick (please read guidance note 7)		On the premises	
Day	Start	Finish	On the premises	Off the premises	Both
Mon	06.00	23.00	<input type="checkbox"/>	<input checked="" type="checkbox"/>	<input type="checkbox"/>
Tue	06.00	23.00	<input type="checkbox"/>	<input type="checkbox"/>	<input type="checkbox"/>
Wed	06.00	23.00	<input type="checkbox"/>	<input type="checkbox"/>	<input type="checkbox"/>
Thu	06.00	23.00	<input type="checkbox"/>	<input type="checkbox"/>	<input type="checkbox"/>
Fri	06.00	23.00	<input type="checkbox"/>	<input type="checkbox"/>	<input type="checkbox"/>
Sat	06.00	23.00	<input type="checkbox"/>	<input type="checkbox"/>	<input type="checkbox"/>
Sun	06.00	23.00	<input type="checkbox"/>	<input type="checkbox"/>	<input type="checkbox"/>

State any seasonal variations for the supply of alcohol (please read guidance note 4)

Non standard timings. Where you intend to use the premises for the supply of alcohol at different times to those listed in the columns on the left, please list (please read guidance note 5)

State the name and details of the individual whom you wish to specify on the license as designated premises supervisor:

Name: CHRISTOPHER JOHN MITCHENER

Address: WALNUTS
32 CHURCH ROAD
LOCKES HEATH
SOUTHAMPTON

Postcode: SO31 6JJ

Personal license number (if known): 2005/00407/06828C

Issuing licensing authority (if known): EASTLEIGH BOROUGH COUNCIL

M Describe the steps you intend to take to promote the four licensing objectives:

a. General - all four licensing objectives (please refer to notes)

ALARM SYSTEM WITH PANIC BUTTONS, CCTV SYSTEM WITH RECORDING FACILITIES AND 28 DAY LIBRARY, TRAINED STAFF WITH RECORDED ONGOING ALCOHOL TRAINING REGIME, CHALLENGE 25 AND PROOF OF AGE INITIATIVE ENRICHED, INSTORE CHALLENGE SIGNAGE, REFUSALS SYSTEM WITH REFUSALS BOOK AND INCIDENT BOOK

b) The prevention of crime and disorder

CCTV SYSTEM WITH RECORDING FACILITY, TRAINED STAFF, CHALLENGE 25, REFUSALS SYSTEM

c. Public safety

STAFF TRAINED IN FIRE SAFETY PROCEDURES AND THE USE OF FIRE SAFETY EQUIPMENT, FIRE FIGHTING EQUIPMENT

d. The prevention of public nuisance

STAFF TRAINED TO DEAL WITH SITUATIONS, USABLE WASTE BINS PROVIDED ON THE FORECOURT

e. The safety of children from harm

FULL ALCOHOL TRAINING REGIME IN USE, ONGOING RECORDED ALCOHOL TRAINING AND REFRESHER TRAINING, CHALLENGE 25 TRAINING INITIATIVE ENRICHED, CHALLENGE SIGNAGE, REFUSALS SYSTEM AND REFUSALS BOOK AND INCIDENT LOG IN USE

K

Please highlight any adult entertainment or services, activities, other entertainment or activities ancillary to the use of the premises that may give rise to concerns in respect of children (please read guidance note 4).

NONE

L

Hours premises are open to the public		
Day	Start	Finish
Mon	00.00	24.00
Tue	00.00	24.00
Wed	00.00	24.00
Thur	00.00	24.00
Fri	00.00	24.00
Sat	00.00	24.00
Sun	00.00	24.00

State any seasonal variations (please read guidance note 4)

Non standard times: (If there are any please refer to the notes in the back of the application form. Please refer to the notes on the back of the application form.) (please read guidance note 5)

Checklist:

- Please tick to indicate agreement
- I have made or enclosed payment of the fee.
 - I have enclosed the plan of the premises.
 - I have sent copies of this application and the plan to responsible authorities and others where applicable.
 - I have enclosed the consent form completed by the individual I wish to be designated premises supervisor, if applicable.
 - I understand that I must now advertise my application.
 - I understand that if I do not comply with the above requirements my application will be refused.

IT IS AN OFFENCE, LIABLE ON SUMMARY CONVICTION TO A FINE NOT EXCEEDING LEVEL 5 ON THE STANDARD SCALE, UNDER SECTION 158 OF THE LICENSING ACT 2003, TO MAKE A FALSE STATEMENT IN OR IN CONNECTION WITH THIS APPLICATION.

Part 4 - Signatures (please read guidance note 10)

Signature of applicant or applicant's collector or other duly authorised agent. If signing on behalf of the applicant, please state address note 11).

Signature	
Date	5 th September 2016
Capacity	LICENSING SOLUTIONS - DULY AUTHORISED AGENT

For joint applications, signature of 1st applicant or 2nd applicant's collector or other authorised agent (please read guidance note 12). If signing on behalf of the applicant, please state in what capacity.

Signature	
Date	
Capacity	

Contact name (where not previously given) and postal address for correspondence associated with this application (please read guidance note 15)
LICENSING SOLUTIONS
32 CHURCH ROAD
LOCKES HEATH

Post town	SOUTHAMPTON	Postcode	SO8 1 6JU
Telephone number (if any)	07831 159 450		
If you would prefer us to correspond with you by e-mail, your e-mail address (optional) starting (if necessary) business.org.uk			

Notes for Guidance

1. Describe the premises, for example the type of premises, its general situation and layout and any other information which could be relevant to the licensing objectives. Where your application includes off-supplies of alcohol and you intend to provide a place for consumption of those off-supplies, you must include a description of where the place will be and its proximity to the premises.
2. Where taking place in a building or other structure please tick on appropriate (boxes may include a tent).
3. For example the type of activity to be undertaken, if not already stated and give relevant further details, for example (but not exclusively) whether or not minors will be employed or unaccompanied.
4. For example (but not exclusively), where the activity will occur on additional days during the summer months.
5. For example (but not exclusively), where you wish the activity to go on longer on a particular day e.g. Christmas Eve.
6. Please give timings in 24 hour clock (e.g. 16:00) and only give details for the days of the week when you intend the premises to be used for the activity.
7. If you wish people to be able to consume alcohol on the premises, please tick 'on the premises'. If you wish people to be able to purchase alcohol to consume away from the premises, please tick 'off the premises'. If you wish people to be able to do both, please tick 'both'.
8. Please give information about anything intended to occur at the premises or ancillary to the use of the premises which may give rise to concern in respect of children, regardless of whether you intend children to have access to the premises, for example (but not exclusively) nearby or nearby, films for restricted age groups or the presence of gaming machines.
9. Please list here steps you will take to promote all four licensing objectives together.
10. The application form must be signed.
11. An applicant's agent (for example solicitor) may sign the form on their behalf provided that they have actual authority to do so.
12. Where there is more than one applicant, each of the applicant or their respective agent must sign the application form.
13. This is the address which we shall use to correspond with you about this application.

M

Consent of individual to being specified as premises supervisor

ICHRISTOPHER JOHN MITCHENER.....
[full name of prospective premises supervisor]

of.....
.....
.....
[home address of prospective premises supervisor]

hereby confirm that I give my consent to be specified as the designated premises supervisor in relation to the application forA NEW PREMISES LICENCE.....[type of application]

by.....MOTOR FUEL LIMITED[name of applicant]

relating to a premises licenceNEW APPLICATION.....
[number of existing licence, if any]

for.....HYDE ROAD FILLING STATION, HYDE ROAD, MOTTRAM, HYDE, SK14 6NG.....
[name and address of premises to which the application relates]

and any premises licence to be granted or varied in respect of this application made byMOTOR FUEL LIMITED[name of applicant]

concerning the supply of alcohol at HYDE ROAD FILLING STATION, HYDE ROAD, MOTTRAM, HYDE, SK14 6NG
[name and address of premises to which application relates].

I also confirm that I am applying for, intend to apply for or currently hold a personal licence, details of which I set out below.

Personal licence number.....2005/00407/06EPEC.....
[insert personal licence number, if any]

Personal licence Issuing authorityEASTLEIGH BOROUGH COUNCIL
[insert name and address and telephone number of personal licence issuing authority, if any]

..... ..signed
.....CHRIS MITCHENER.....name (please print)
.....2ND SEPTEMBER 2016.....dated

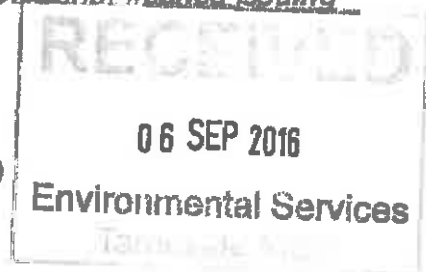

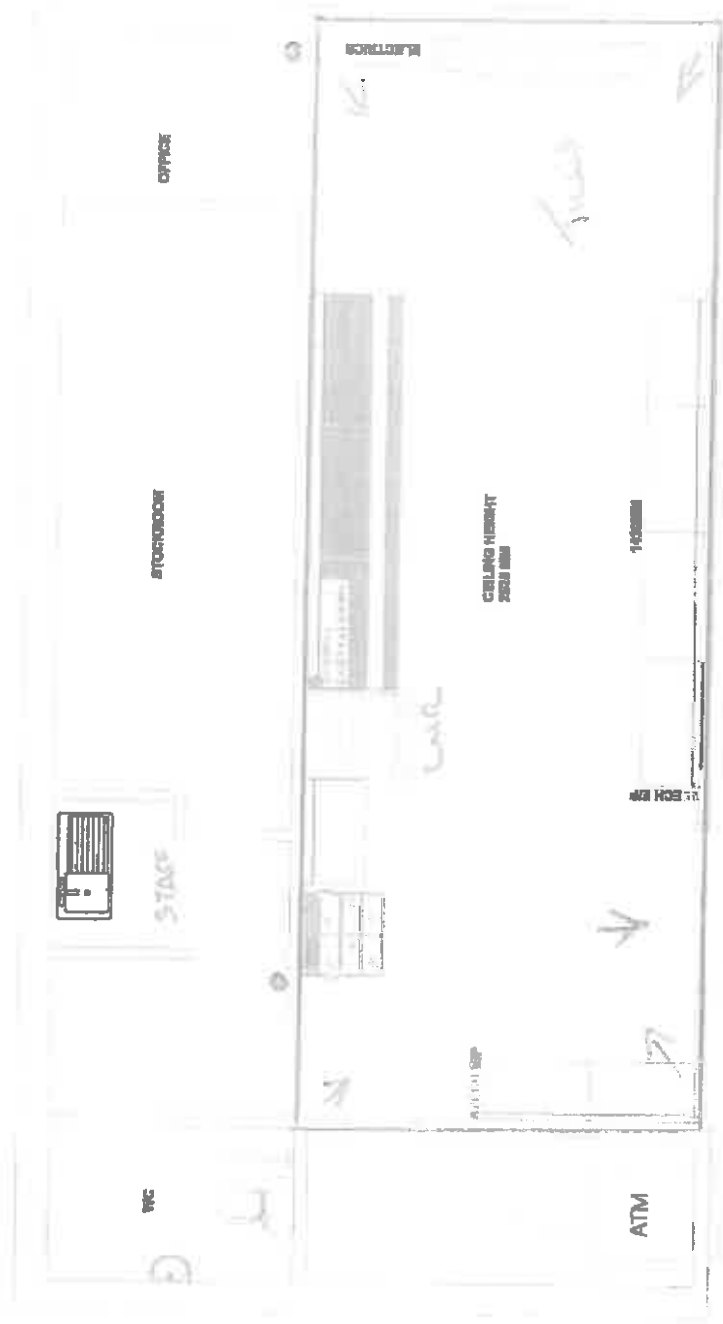

ALLOWED DISPLAY TERMINAL NOT TO BE SEEN WITHIN THE R.F.S BOUNDARY

BLINDON INVESTIGATION
 THE JORDON GROUP
 CLAREMONT
 100 BUCKINGHAM
 ROAD
 WIMBORNE
 DORSET BH20 2BA
 T: 01202 881880
 F: 01202 881880
 E: www.jordan.co.uk
 info@jordan.co.uk



PROPOSAL		CLIENT NAME		PROPOSAL NO.		DATE	
DATE	1/11/11	PROJECT NAME	FS 358	PROPOSAL NO.	11/001	DATE	11/001
DESCRIPTION	W/LI C/TV KITCHEN	CLIENT ADDRESS	MOTTISHAM	PROPOSAL NO.		DATE	
PROPOSAL NO.		PROPOSAL NO.		PROPOSAL NO.		DATE	

THE JORDON GROUP
 CLAREMONT
 100 BUCKINGHAM
 ROAD
 WIMBORNE
 DORSET BH20 2BA
 T: 01202 881880
 F: 01202 881880
 E: www.jordan.co.uk
 info@jordan.co.uk

Analysis of Projected Customer Flow
Client Name: Motor Fuel Ltd - Convenience Store
Hyde Road

	Shop Sales - £	Average Shop Purchase - £	Number of Shop Customers	Number of Fuel Litres	Average Fuel Purchase - Litres	Fuel Sales - Litres
Month 1	52144	3.14	16606	13954	18.76	261784
Month 2	53239	3.17	16771	14003	18.75	262517
Month 3	54357	3.21	16939	14053	18.73	263252
Month 4	55499	3.24	17111	14102	18.72	263989
Month 5	56664	3.28	17287	14152	18.71	264728
Month 6	57854	3.31	17467	14202	18.69	265470
Month 7	59069	3.35	17650	14252	18.68	266213
Month 8	60309	3.38	17837	14302	18.67	266958
Month 9	61576	3.42	18028	14352	18.65	267706
Month 10	62869	3.45	18223	14403	18.64	268455
Month 11	64189	3.48	18421	14454	18.63	269207
Month 12	65537	3.52	18624	14505	18.61	269961
Totals	703306	3.33	210965	170734	18.69	3190240

Analysis of Projected Customer Flow
Shop v Forecourt
Motor Fuel Ltd - Convenience Store
Hyde Road



By virtue of paragraph(s) 3 of Part 1 of Schedule 12A
of the Local Government Act 1972.

Document is Restricted

This page is intentionally left blank

By virtue of paragraph(s) 3 of Part 1 of Schedule 12A
of the Local Government Act 1972.

Document is Restricted

This page is intentionally left blank